

# HYATT REGENCY LONDON OLYMPIA



HYATT  
REGENCY™  
LONDON OLYMPIA





# EMBRACE COMFORT

## *Connect with convenience*

Hyatt Regency London Olympia blends modern five-star comfort with unrivalled access to Olympia London's world-class events. Perfectly placed in West London, the hotel offers a seamless base for business and leisure travelers, connecting them to iconic landmarks, vibrant dining and cultural experiences. With intuitive service and a genuine sense of community, every stay is designed to Inspire an Open Outlook.



# UNBEATABLE CENTRAL LONDON LOCATION

EXPERIENCE ALL  
*London offers*

## LANDMARKS

- ◆ Hammersmith Apollo Theatre
- ◆ Shepherd's Bush Empire
- ◆ Westfield Shopping Centre
- ◆ Portobello Road Market
- ◆ Olympia
- ◆ Design Museum
- ◆ Kensington Palace
- ◆ Royal Albert Hall
- ◆ Natural History Museum
- ◆ V&A Museum
- ◆ Harrods
- ◆ Wellington Arch
- ◆ Buckingham Palace
- ◆ Big Ben and Parliament
- ◆ London Eye
- ◆ Trafalgar Square
- ◆ Piccadilly Circus
- ◆ Marble Arch
- ◆ British Museum
- ◆ Tate Britain Gallery
- ◆ Battersea Power Station

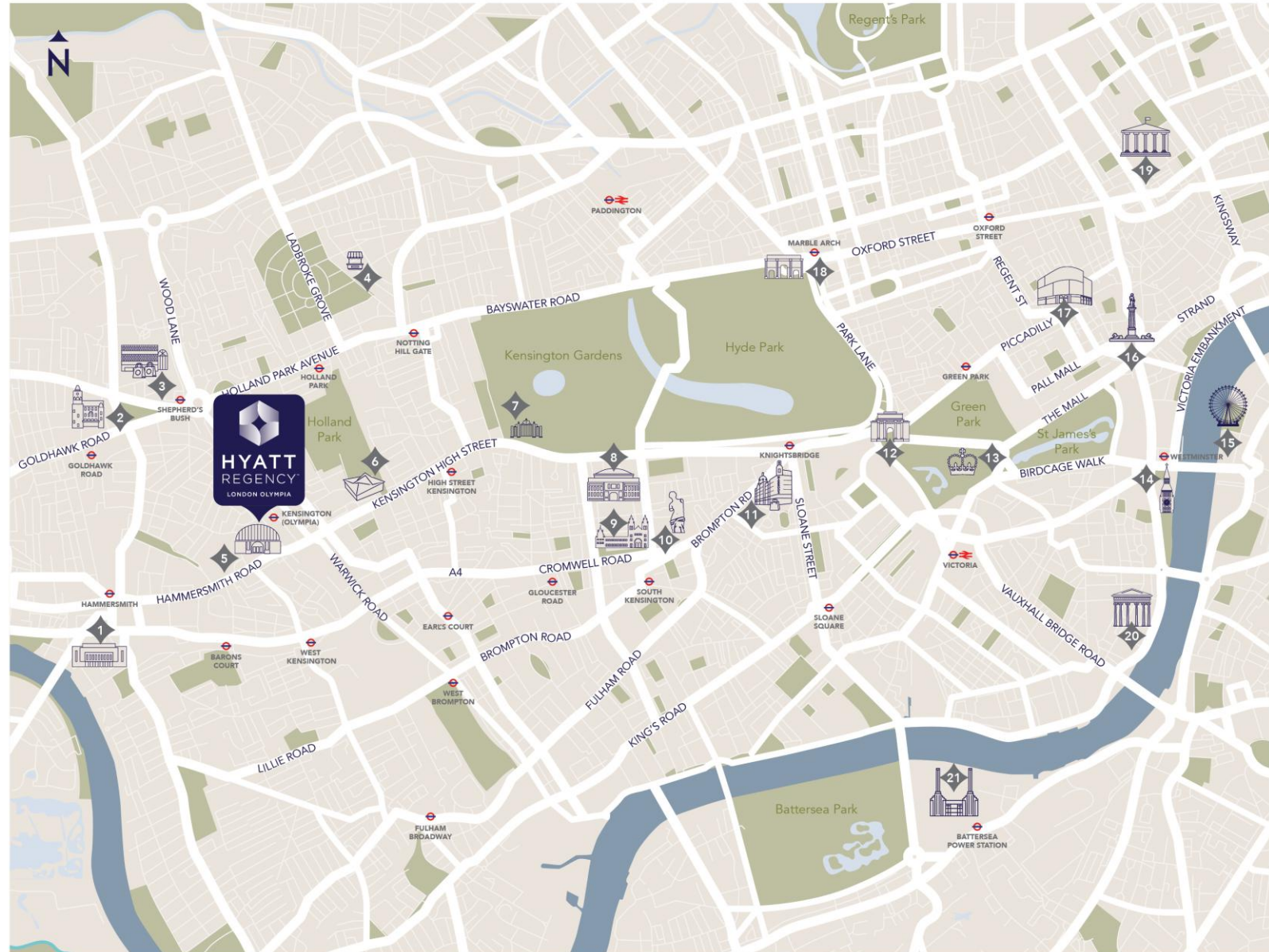

# CONVENIENTLY CONNECTED

## LONDON *Connections*

### AIRPORTS

-  London Heathrow, 12 miles
-  London City, 13 miles
-  London Gatwick, 35 miles
-  London Stansted, 47 miles

### STATIONS

-  Kensington (Olympia), 0 miles
-  West Kensington, 0.6 miles
-  High Street Kensington, 0.8 miles
-  Barons Court, 0.8 miles
-  Hammersmith, 0.9 miles
-  Shepherd's Bush, 1.2 miles
-  Notting Hill Gate, 1.4 miles

### GREEN SPACES

-  Holland Park, 0.6 miles / 12 mins walk
-  Kensington Gardens, 1 mile / 20 mins walk
-  Hyde Park, 1.2 miles / 25 mins walk



# AN OPEN INVITATION TO EXPLORE *Olympia Reborn*

**Hyatt Regency London Olympia** is ideally located in West London's iconic Olympia, a destination steeped in over 139 years of global innovation, culture, and entertainment since its opening in 1886.

Undergoing a dynamic transformation, Olympia is being reimagined through a major redevelopment that brings new energy to the area. Set between the prestigious Royal Borough of Kensington and Chelsea and the vibrant Borough of Hammersmith and Fulham, the hotel enjoys a prime location near world-famous landmarks like the Royal Albert Hall and Kensington Palace.

With a brand-new convention centre, upgraded event spaces, and an exciting mix of dining and entertainment, Hyatt Regency London Olympia is where business meets inspiration - the perfect place to connect, recharge, and unwind.



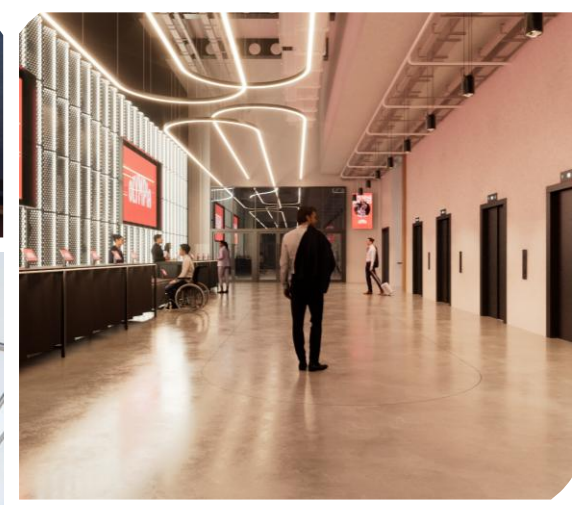

# OLYMPIA IN NUMBERS

## *At a glance*

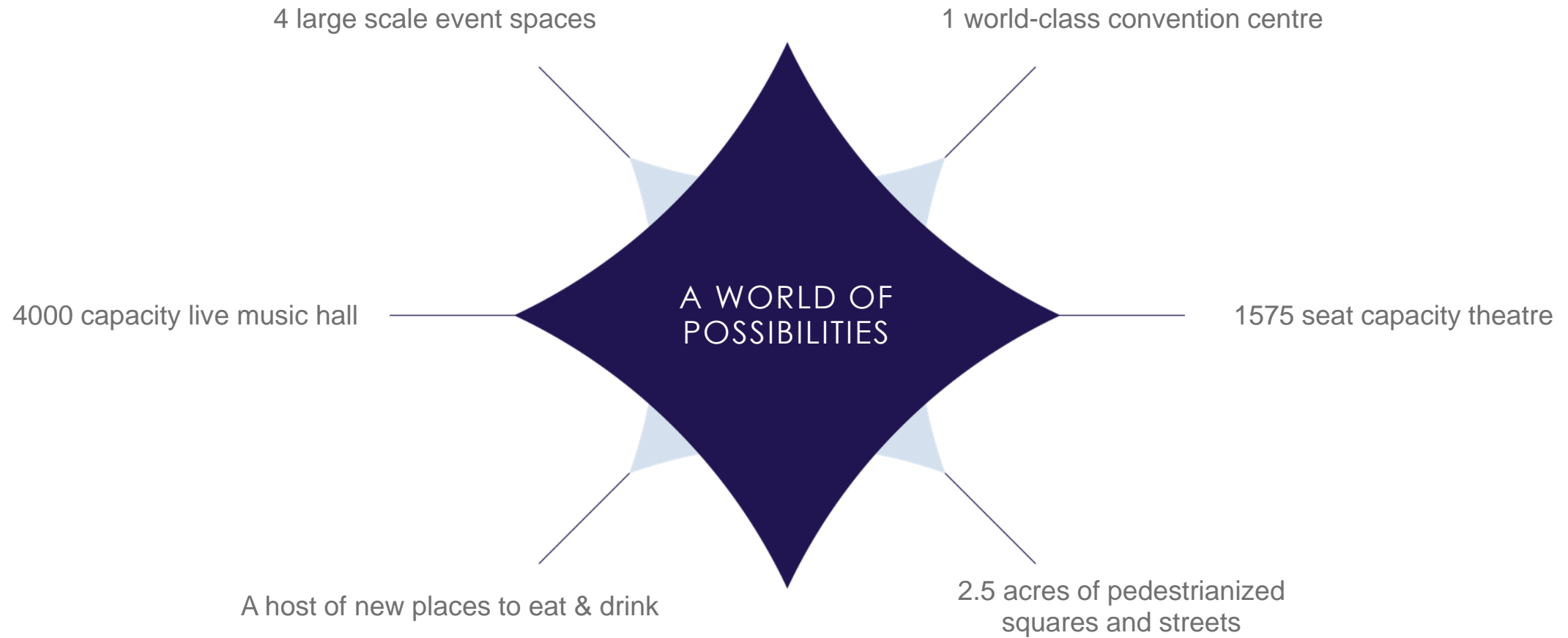

# ACCOMMODATION

## *Rooms*

Step into a bright, contemporary guest room, thoughtfully designed to balance comfort and functionality.

Rooms feature refined wood accents, a 65" TV, and inviting lounge seating. From the Deluxe category and above, a dedicated work area is included-ideal for both business and leisure stays.

Guest rooms range from 24 to 48 sqm, with many offering views across revitalised Olympia and distinctive London rooftops, creating a peaceful urban retreat.

The hotel features a total of 204 guestrooms, including 180 bedrooms, across a range of carefully considered categories-each designed to provide a seamless and relaxing stay in one of London's most characterful and well-connected neighbourhood.





### 1 King Bed High Floor

Take in stunning London vistas through floor-to-ceiling windows in this 24 to 27 sqm contemporary retreat. Featuring a king-size bed, 65" TV, cozy reading sofa, and walk-in rain shower. With 26 rooms in this category, guests can enjoy a thoughtfully designed room experience with elevated views.



### 1 King & 2 Twin Beds

Unwind in a spacious 24 to 27 sqm contemporary room. Featuring a king-size bed or twin configuration, 65" TV, cozy reading sofa, and walk-in rain shower across 89 thoughtfully designed rooms.



### 1 King Bed, 2 Twin Beds Deluxe & 1 King Bed, 2 Twin Beds Deluxe Accessible

Thoughtfully designed with a king-size bed or twin bed, 65" TV, flexible working area, cozy reading sofa, and walk-in rain shower. This category comprises 65 rooms, delivering accessible comfort in select rooms with carefully considered layouts and design.

## ACCOMMODATION

### *Premium Rooms & Suites*



Discover elevated comfort in these modern suites, including a selection with private terraces, where sleek design meets thoughtful detail. Featuring soft neutrals, teal accents, and warm wood tones, the space offers a refined, residential feel.

Enjoy a chic lounge area with a designer sofa, curated art, and ambient lighting. A dedicated work desk and glass partitions balance privacy and openness, creating a seamless environment for both work and relaxation.

Suites and Premium Corner rooms range from 35–53 sqm, each thoughtfully designed to offer a generous sense of space, defined by comfort and quiet refinement.





## Family Room

Designed for comfort and convenience, this spacious family-friendly retreat features two connecting rooms. This category features three rooms, ideal for families looking for additional space and privacy.



## 1 King Bed Premium Corner & 2 Twin Beds Premium

Enjoy 41 to 45 sqm of comfort in this generously sized room featuring a king-size bed, 65" TV, dedicated work area, cozy reading nook & a large, well-appointed bathroom.

With 14 rooms in this category, guests can enjoy a more exclusive room offering with enhanced space and layout.



## Regency Suite

Immerse yourself in the comfort of this Regency Suite, featuring a king-size bed, 65" TV, dedicated work area, separate living space, and a large, well-appointed bathroom.

With only five suites defining this category, the suites provide a refined balance of space, comfort, and privacy.



## Regency Executive Suite

Take in stunning London views from the Regency Executive Suite, featuring a king-size bed, 65" TV, dedicated work area, separate living space, and a spacious, well-appointed bathroom.

This category comprises three suites, designed for guests seeking enhanced space, privacy, and comfort.



## 1 King Bed Premium Corner with Terrace

Enjoy 45 sqm of thoughtfully designed space featuring a king-size bed, 65" TV, dedicated work area, inviting living space & a large bathroom-paired with exclusive access to a private terrace. Perfectly suited for both productivity & peaceful retreat.



## Regency Executive Suite with Terrace

Take in stunning London vistas from the Regency Executive Suite, the pinnacle of our accommodation. Featuring exclusive access to a private terrace, a dedicated work area, separate living space, and a well-appointed bathroom. A truly unique offering, this singular suite invites a more elevated way to experience West London.

## FOOD & BEVERAGE

### *The 1937 Lounge & Bar & The Market*



The **1937 Lounge & Bar** sits at the heart of the lobby, radiating a warm and welcoming ambiance. Enjoy expertly brewed coffee, light bites, finely crafted beers, and timeless cocktails in a space thoughtfully designed for relaxation and connection. Whether you're kickstarting your morning or winding down after an event, it's the ideal place to pause, refresh, and reconnect.

Conveniently situated on the ground floor, **The Market** is a Grab & Go corner offering a curated selection of essentials and culinary delights. Thoughtfully chosen or freshly prepared by our chefs, the assortment includes a wide range of food and beverages tailored to meet the needs of today's modern traveler.



## PILLAR HALL *Idalia & Upstairs at Pillar Hall*

### **Idalia**

A vibrant 300-cover, all-day dining destination, Idalia celebrates Modern British cuisine within a setting inspired by Aphrodite, goddess of beauty and light — a fitting tribute to the grandeur of Pillar Hall, built in the 1880s when the name Idalia first rose to prominence. Guests are taken on a journey through a lush conservatory, a theatrical cocktail bar, and into a warm, glamorous dining room, with a 50-seat terrace extending out into Olympia's Grand Hall.

### **Upstairs at Pillar Hall**

A spectacular 500-capacity event space set within historic Pillar Hall. Perfect for large-scale celebrations and corporate events, the venue combines architectural grandeur with vibrant energy — enhanced by live music on weekends — creating a show-stopping backdrop for unforgettable occasions.

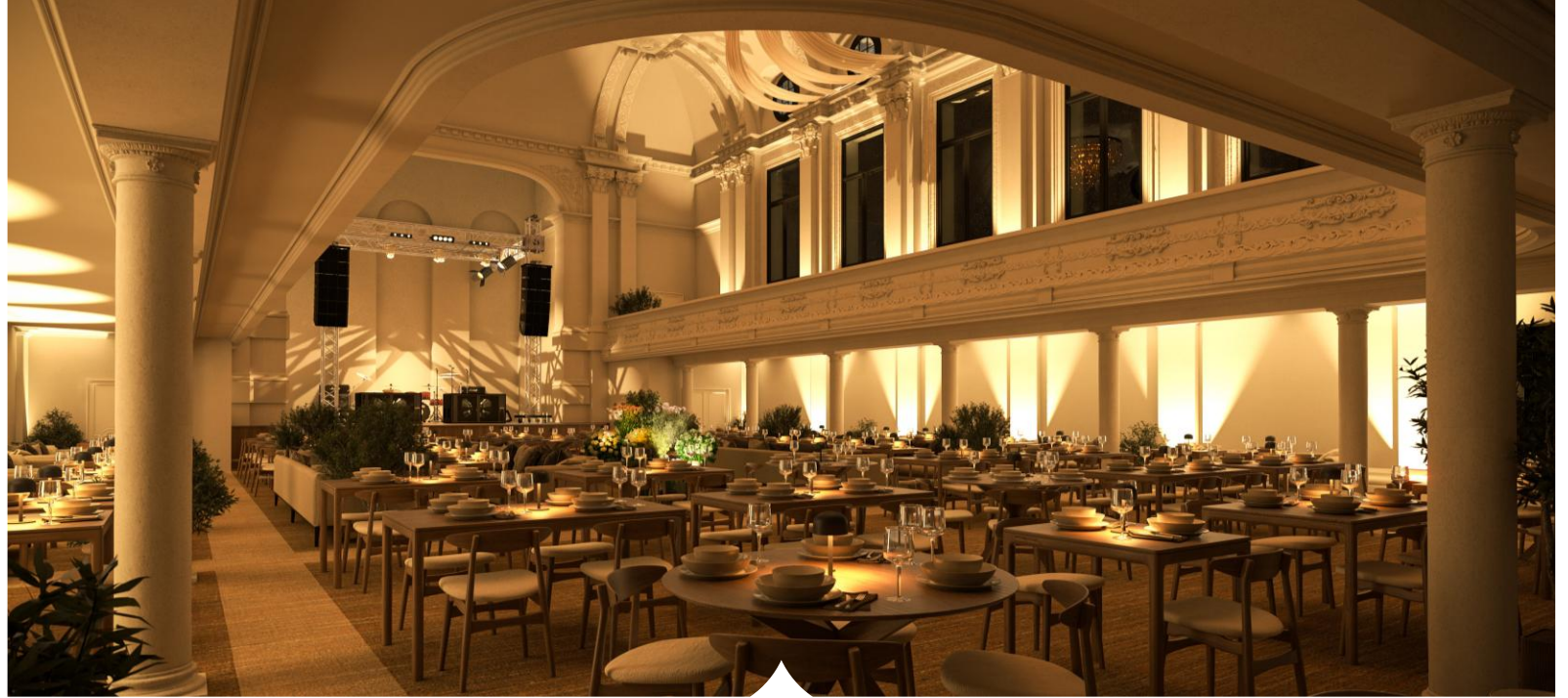

## MEETINGS & *Events Spaces*

Host your next event in our contemporary meeting space, where refined design meets functionality.

With warm wood paneling, curated artwork, and soft natural lighting, the atmosphere is both inviting and professional—ideal for conferences, presentations, and team workshops.

Featuring a total of 84 sqm across three meeting rooms, accommodating up to 62 guests, with an additional foyer space perfect for breaks or informal gatherings.

Equipped with integrated AV technology, the venue offers a flexible layout that can be effortlessly divided into three separate rooms.

Whether you need a theatre-style setup, classroom arrangement, or a boardroom configuration, our versatile space adapts to suit your needs.





FLOOR PLAN  
GROUND FLOOR

FIRST FLOOR

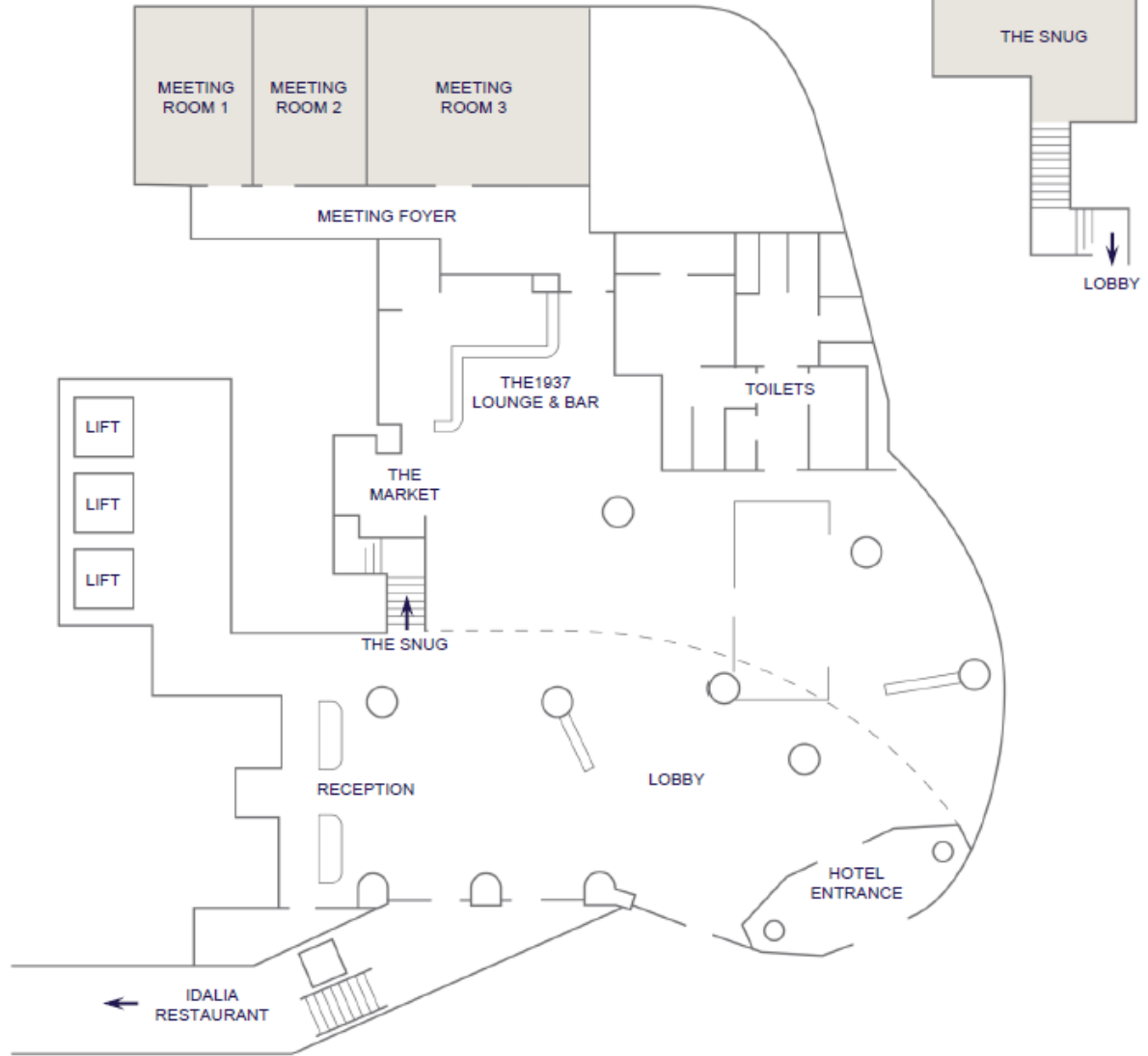

## CAPACITY DETAILS



Room Name	Room Dimensions L x W x H	Room Size Sq. M. / Sq. Ft.	Cabaret	Reception	Theatre	Classroom	Boardroom	U-Shape	Hollow Square
<b>Ground Floor</b>									
MEETING ROOM 1	3.7m x 5.5m x 2.8m 12' x 18' x 9'	20.6 221	-	18	14	10	8	8	-
MEETING ROOM 2	3.5m x 5.5m x 2.8m 11' x 18' x 9'	20.7 221	-	18	14	10	8	8	-
MEETING ROOM 3	7.4m x 5.5m x 2.8m 24' x 18' x 9'	41.3 444	18	30	24	20	16	16	20
MEETING ROOM 1+2	7.4m x 5.5m x 2.8m 23' x 18' x 9'	40.5 435	18	30	24	20	16	16	20
MEETING ROOM 2+3	10.9m x 5.5m x 2.8m 35' x 18' x 9'	61.1 657	24	50	42	28	24	24	28
THE MEETING ROOM	14.9m x 5.5m x 2.8m 48' x 18' x 9'	83.3 896	30	70	62	34	40	36	40
MEETING FOYER		23.6 254	-	30	-	-	-	-	-
<b>First Floor</b>									
THE SNUG	6.6m x 4.2m x 2.8m 24' x 18' x 9'	27.7 291	-	16	-	-	-	-	-

THANK  
*You*



Director of Sales & Marketing  
+44 734 543 81 56  
[yanal.tarazi@hyatt.com](mailto:yanal.tarazi@hyatt.com)  
[hyattregencylondonolympia.com](http://hyattregencylondonolympia.com)



**HYATT**  
REGENCY™  
LONDON OLYMPIA